

Clinton native named as United Ministries' executive director

Special to The Clinton Courier

United Ministries recently announced the selection Lizzie Beber as their new executive director. Beber is a Clinton native and Mississippi College graduate and is the daughter of Dr. Cliff and Melanie Fortenberry of Clinton.

In announcing their selection of Beber, United Ministries said that, in her career, Beber has shown her dedication to compassionate and loving concern for those living at the margins and brings both nonprofit and leadership experience to United Ministries, encompassing commu-

nications, board engagement, partnership development, organizational planning and fundraising.

Since 2008, Beber has worked for Christ House in Washington, DC, a medical respite organization that provides dignifying healthcare to sick and homeless persons. Beber says she delights in working for a more loving, just, and equitable world, and finds this work realized through communities and partnerships who are committed to hope, healing, and radical hospitality.

When United Ministries and GAIHN joined together in 2016, a



Lizzie Beber

timeline for succession of executive leadership was established. The board of United Ministries formed an

executive search committee in May 2019 to set the timeline into motion. Beber was selected after extensive interviews. She will share executive leadership of the agency with Ethan Friddle, Director of Programs and Operations.

"Lizzie has a unique blend of experience and expertise that will position her well to guide United Ministries and the community into the future," said Tony McDade, retiring executive director. "I am excited to welcome her to our United Ministries family and to introduce her to our many friends in the community."

CENTURY 21 David Stevens, Inc • 601-924-7552 • century21davidstevens.com



Clinton's Real Estate Experts
For Over 40 Years

AGENT OF THE MONTH



Debbie Thomas
Congratulations!!

MADISON



NEW LISTING

127 MULLHERRIN DR

- HATHEWAY LAKE
- 3 BR / 3 BA
- Approx. 2462 SF

CALL SHELLY JANOUS
601-988-7070

CLINTON



NEW LISTING

201 SHADOW COVE

- HANGING MOSS OF TRAILWOOD SUBDIVISION
- 3 BR/ 2BA
- 1463 SF

CALL DAVID STEVENS II
601-540-1219

BELZONI



NEW LISTING

514 ROSE DR

- 4 BR / 2.5 BA
- Approx. 2037 SF

CALL DEBBIE THOMAS
601-941-7361

CLINTON

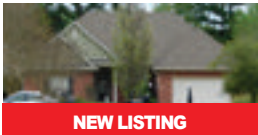

NEW LISTING

122 OAKLEIGH DR

- OAKHURST SUBDIVISION
- 4 BR / 2 BA with Approx. 2220 SF
- Split Plan in a Cul-de-sac

CALL DEBBIE THOMAS
601-941-7361

CLINTON



200 HAMPTON ST

- HUNTCLIFF SUBDIVISION
- 4 BR / 2 BA with Approx. 2081 SF
- All new flooring, paint & appliances

CALL JACKIE BARKSDALE
601.918.2914

EDWARDS



1070 CEMETARY RD

- Located btwn Clinton & Vicksburg
- 3 BR/2BA WITH Approx. 1225 SF
- Fresh paint, carpet & roof

CALL JARED FLEMING
601.906.8609

YAZOO CITY



1120 JACKSON AVE

- LINTONIA ADDITION
- 3BR/ 1.5BA with Approx. 2011 SF
- Bungalow with Original Hardwood Floors

CALL SHELLY JANOUS
601-988-7070

CLINTON



106 CONCORD DR

- OLDE VINEYARD SUBDIVISION
- 4 BR / 2.5 BATH APPROX. 2752 SF
- IN GROUND SWIMMING POOL

CALL DAVID STEVENS II
601-540-1219

CLINTON

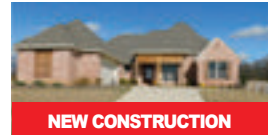

NEW CONSTRUCTION

134 FREELAND LN

- WINDSOR PLANTATION
- 4BR/3BA Split Plan Approx 2350 SF
- Covered Patio with Fireplace

CALL DEBBIE THOMAS 601-941-7361

CLINTON



NEW CONSTRUCTION

192 CATHERINE BLVD

- WINDSOR PLANTATION
- 4BR/3BA Approx. 2285 SF
- Covered Patio with Fireplace

CALL DEBBIE THOMAS 601-941-7361

CLINTON



NEW CONSTRUCTION

128 FREELAND LN

- WINDSOR PLANTATION
- 4BR/3BA Approx. 2421 SF
- Covered Patio with Fireplace

CALL DEBBIE THOMAS 601-941-7361

CLINTON



219 HANNAH DRIVE

- GREEN ACRES SUBDIVISION
- 4 BR/2.5 BA Approx. 2570 SF
- Freshly Painted Split-Level Home

CALL SHELLY WITHERS-JANOUS
601-988-7070

CLINTON



222 HANNAH DRIVE

- GREEN ACRES SUBDIVISION
- 4BR/3BA, Approx. 3241 SF
- Den, Family Room and Formal Living Room

CALL CHARLA CONLEE @
601.954.4565

JACKSON



1838 NORTHWOOD CIR.

- RICHWOOD ESTATES
- 4BR/2.5BA Approx. 2503 SF
- Completely Renovated

CALL DEBBIE THOMAS 601-941-7361

CLINTON



113 NAPA VALLEY DR.

- OLDE VINEYARD SUBDIVISION
- 4BR/3.5BA Approx. 3860 SF
- Swimming Pool, Cabana & Hot Tub

CALL JACKIE DALTON 601-594-5344

JACKSON



3560 HORTON DR

- ELRAINE RESY SUBDIVISION
- 3 BR/2BA Approx. 1140 SF
- Great for Investors

CALL SHELLY JANOUS 601-988-7070

FLORA

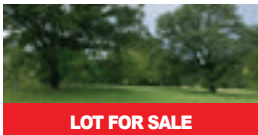

LOT FOR SALE

0 WEATHERBY WAY

- HEARTLAND ESTATES SUBDIVISION
- 4.57 ACRE LOT IN A CUL-DE-SAC
- Must See the Oak Trees on this lot

CALL DAVID STEVENS II
601-540-1219

CLINTON

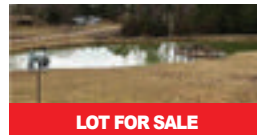

LOT FOR SALE

2625 MCGUFFEE ROAD

- Beautiful Piece of Land
- 5 Acre Lot in Clinton

CALL SHELLY WITHERS-JANOUS
601-988-7070

CLINTON

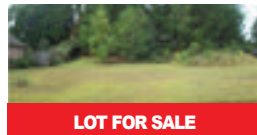

LOT FOR SALE

128 CHOCTAW BEND

- INDIAN TRAILS SUBDIVISION
- Conveniently Located Near Schools
- Minimum of 1600 SF New Construction

CALL JACKIE DALTON 601-594-5344

CLINTON

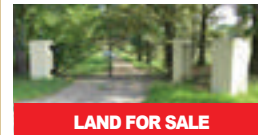

LAND FOR SALE

1180 NOAH JOHNSON RD

- 107 Acres
- Beautiful Gently Rolling Farm Land
- Couple of Ponds

CALL CENTURY 21 DAVID STEVENS
INC 601-924-7552

CLINTON



COMMERCIAL

1537 BIEDENHARN COVE

- 12, 500 SF BUILDING – CLINTON INDUSTRIAL
- BACKS UP TO A BEAUTIFUL LAKE
- USE FOR STORAGE, RECREATIONAL

CALL JACKIE DALTON 601-594-5344

701 Highway 80 West • Clinton, Mississippi 39056